

Cloud workflows for remote post-production

How to ensure assets stay centralised and
secure without compromising flexibility





It's time to plan the next phase of your facility

As one of the UK's most experienced media solutions providers, with a unique knowledge of infrastructure and cloud computing, we're here to support you and your facility as you determine the future of your business. With over 30 years' experience working with media networks, we can help you weigh your options for remote, hybrid and cloud-first work.

Our wide network of vendor relationships and accreditations means that we'll always deliver a solution that suits your workflow, not lock you into a deal with our preferred vendor. We're an Avid Cloud Partner, EditShare Certified Partner, AWS Select Consulting Partner, the UK's only Streambox provider, and partnered with Nutanix and Haivision, so we're here to support remote working at every stage of production and post.

Why choose Jigsaw24 Media?

- With nearly 30 years' successful growth and a turnover of £150 million, we're here to stay – there's no chance of you losing your support provider mid-contract.
- Our customer-first approach means you'll always be dealing with a qualified engineer who understands your facility and its requirements.
- As well as our M&E team's home base in Soho, we've got offices (and engineers) across the UK, ready to help your team wherever they are.

Who do we work with?

BBC Springwatch

We helped the BBC overcome challenges posed by the pandemic, such as needing to process footage from multiple cameras in the field at locations across the UK. The result was the deployment of an AWS-based cloud production workflow that takes more than 30 feeds from traditional broadcast cameras and web cameras into Gallery's Sienna ND system, where they are passed on to a processing engine and router before being available for monitoring by BBC crew members working from home. The use of such cloud technology in the show's production offers additional benefits to the BBC, like potential long-term cost savings and reductions in energy usage and emissions.

"We are incredibly proud of enabling remote production for Springwatch and helping the BBC to revolutionise how it makes programmes. Our experts have led the way in remote production and post-production solutions for many years, making Jigsaw24 Media uniquely positioned to support broadcasters in the current climate, while our media and entertainment engineers have demonstrated their skill and speed time and time again."

Lee South, Head of Service Delivery for Media and Entertainment at Jigsaw24 Media.

IMG Studios

IMG Studios offer production, post and distribution to some of the biggest names in sport, including the Premier League and Serie A. For the last 18 years, we've been providing them with Avid hardware, software, storage and support – as well as a complete KVM solution and advice on special projects.

"We have a very talented support team in-house so we only call out if there's a real, complex problem with our systems. But often vendors will make us jump through every hoop, asking if we've tried turning it off and on again, which is a level of bureaucracy there's no time for when you're trying to get on air. When we call Jigsaw24 Media, it feels like we skip four support tiers and get straight to the issue. We get the kind of deep level support we need faster." **Brian Leonard, Head of Engineering for Production and Workflows, IMG Studios.**



Halo

"Jigsaw24 Media have been fantastic. They know the products inside out and are always available – and more often than not in person. Their in-house facilities in Golden Square are second to none, and their willingness to demonstrate and provide ongoing training goes beyond any after-sales support I've experienced before." **Halo.**

Other people we work with...

GORILLA

FARM



OutPost

evolutions

SPLICE

liquidviolet

Solution spotlight: EditShare and AWS



Sending media out to remote workers is risky – your files may be lost, stolen, damaged or leaked en route, or picked off a poorly-secured home network. It also makes maintaining a cohesive workflow difficult, as assets can't be shared among team members or move along the chain from ingest to edit in a timely manner, and it can be difficult to ensure all work has been backed up, archived or secured sufficiently.

By combining EditShare's on-premise EFS storage with a virtual FLEX deployment hosted in AWS, you can create a simple, synchronised workflow that makes it easier to:

- Back up on-premise files to the cloud.
- Sync in-cloud and on-premise storage.
- Provide a proxy workflow that won't run up download or access fees from your cloud provider.
- Move distributed workers to a hybrid or cloud-first workflow to ensure parity of access and improve version control.
- Move archived projects from Tier 1 storage to a less expensive cloud archive.

Or, put more simply, it helps editors in separate locations work more like the team they need to be, by simplifying asset sharing and offering equal access to all.

The best part is that it's easy to incorporate any existing EditShare licences you have – we can help you connect on-premise storage to the cloud, or consolidate existing cloud storage into a single, powerful instance hosted at our datacentre, in your own private cloud, or by a third party.

What do you get?

What do you get? Purchase your FLEX licences from us, and we can host them in our AWS instance, where they'll be monitored by our experienced, EditShare certified engineers. We'll provide:

- Help building and deploying your EditShare and AWS workflow.
- An ongoing managed service delivered in line with your needs.
- Our specialist media systems support for your entire EditShare and AWS workflow.

A consolidated invoice that makes it easy for you to track all your cloud costs.

Got your own AWS instance and want to take care of it yourself? Our team can provide:

- EditShare FLEX licences.
- Help building and deploying your EditShare and AWS workflow.
- Our specialist media systems support for your entire EditShare and AWS workflow.

How does it work?

EditShare FLEX Cloud Sync

New from EFS in 2021, EditShare CloudSync will run on a 1U server appliance in your current deployment or virtualised in the cloud. It will sync with your existing on-premise EFS storage, including metadata and proxies for FLOW, to cloud volumes and/or local NAS via SMB or NFS.

Each job in Cloud Sync can only sync in one direction, but individual jobs can be set up in both directions, and jobs can be configured for multiple EFS systems on the same Cloud Sync server.

Deletes are not replicated as standard, to preserve files for disaster recovery purposes – a separate sync with deletes can be configured at a reasonable interval to save destination capacity. As supporting files for FLOW are included in the Sync jobs, a cloud copy of the EFS can be used as a source to build a FLEX Cloud Edit deployment – a possible disaster recovery strategy – and FLOW can reference the cloud copies of assets in addition to on-premises files in the index.

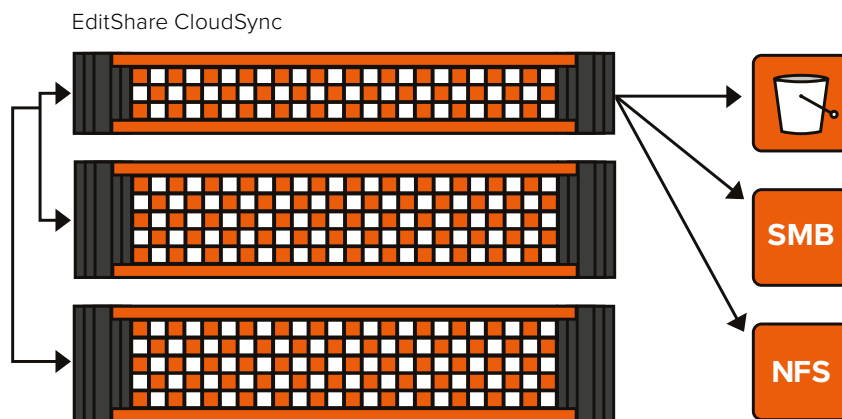

S3 Active Archive

By adding an S3 Standard or Glacier bucket to the FLOW Story to trigger an archive job for individual or groups of assets to this destination.

Permission can also be provided for users to trigger a restore of the source content from the cloud if they require the assets back on EFS storage for editing or

delivery. Whilst the source content is held in the cloud, these original files can be deleted from the tier one storage to save capacity. This leaves behind the low bitrate, FLOW-generated proxies to provide a review platform for content in the archive. In the long term, this saves on egress from the cloud for assets the editor may not need for the project, given there would be an accessible review mechanism in place prior to download.

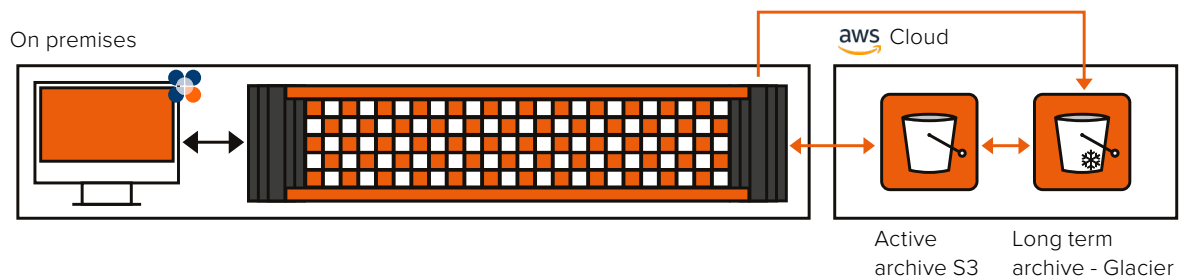

EFS Hybrid Deployment

There are instances where an on-premises EFS and FLOW deployment can be complemented with cloud services. For example, ingest may still be happening in the facility or most editors may still be based on-site. Original content or just FLOW proxies can be uploaded to FLEX in AWS to allow access to remote contributors from further afield. This is achieved from the EFS appliances rather than client upload.

This deployment also avoids the need for remote workers to access on-site resources if they are already in use. Possible remote roles could include logging, cuts-only sequence creation, review and approval.

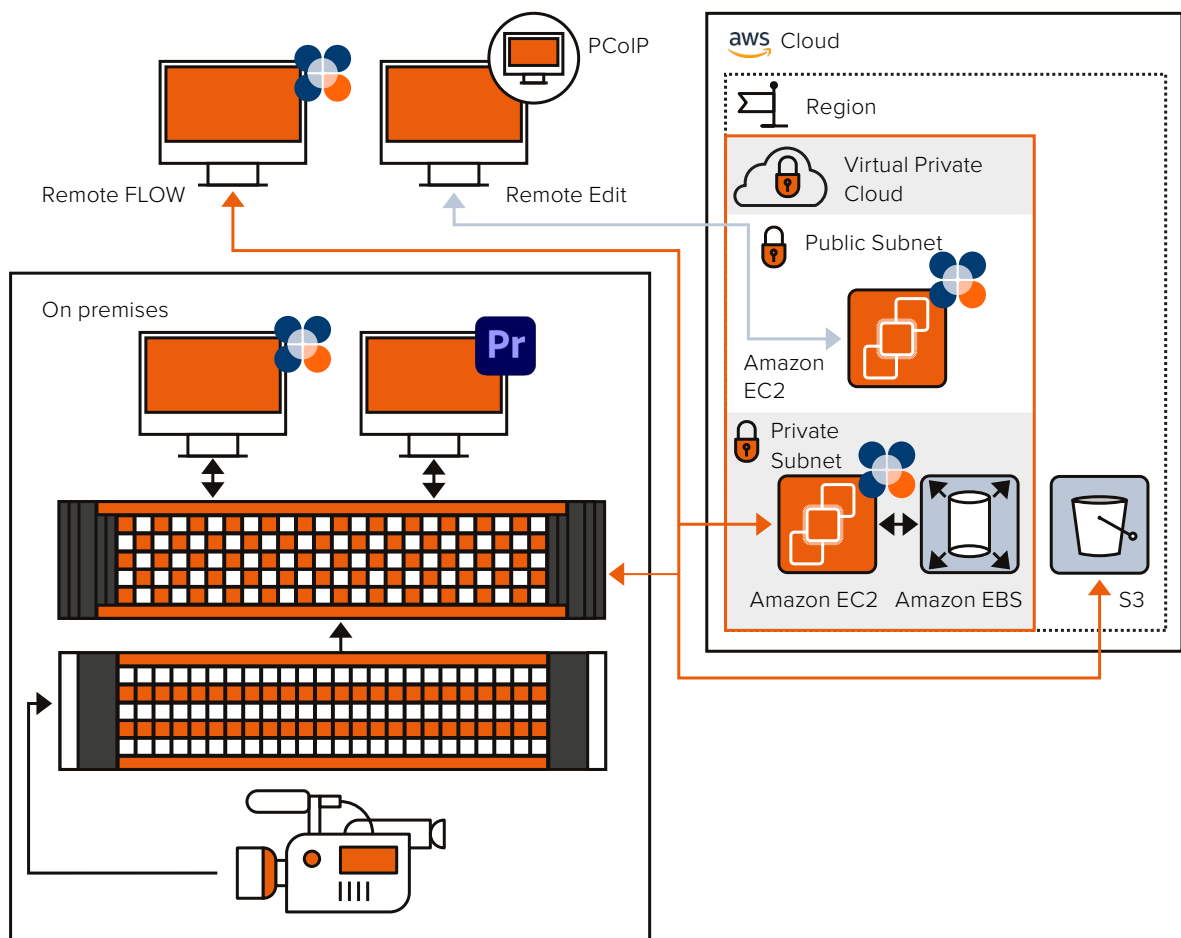

FLEX Cloud Edit and Edit+

The cloud equivalent of an EFS all-in-one appliance. This approach utilizes just one AZ in the chosen region to host all workstation and FLEX instances. EFS storage and FLOW are hosted in a private subnet in AWS VPC, then linked up with NLE workstations hosted on GPU-equipped EC2 in a public subnet.

Remote clients can include: use of FLOW tools directly, including Story and AirFLOW; PColP clients connecting to the cloud workstations; and clients equipped with file acceleration software for remote upload of media assets into FLEX or S3.

While there is no immediate redundancy or high availability that would be offered by multi-AZ deployments, with consideration given to backup and the saving of metadata, EC2 images could be redeployed if needed, and this would be much faster than redeploying on-premises hardware. The use of S3 and EBS together can provide a platform for the “Seamless Proxy Editing” feature.

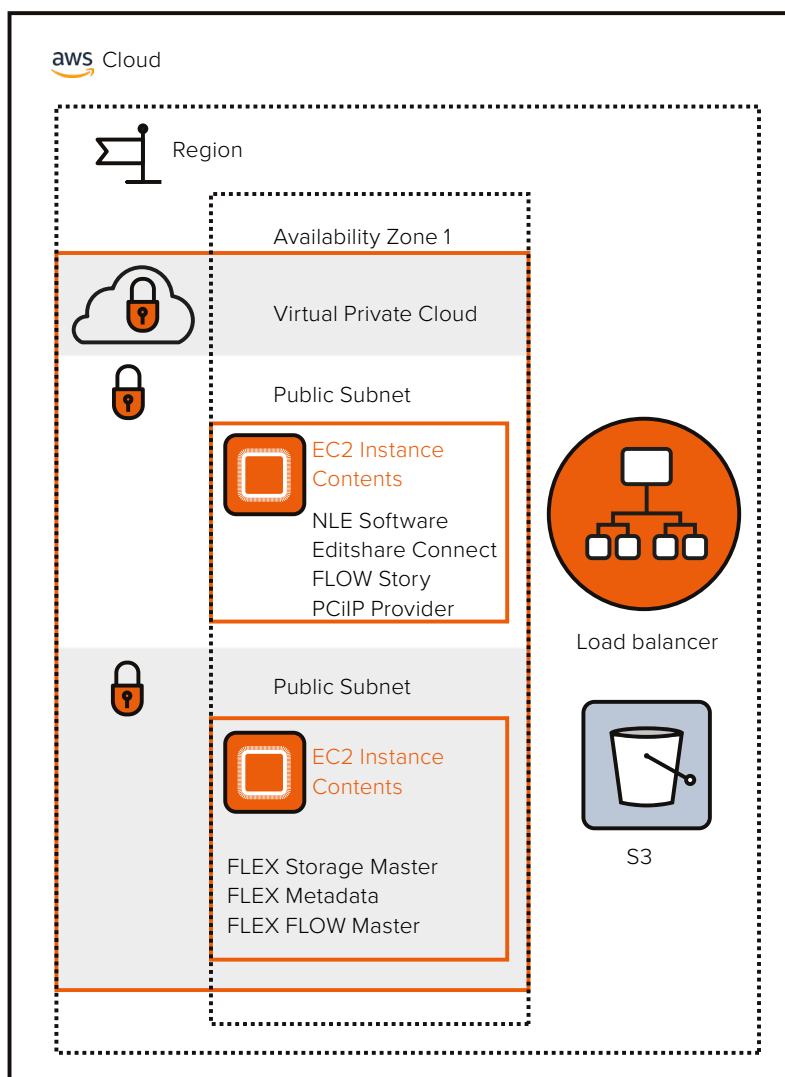

Remote client options

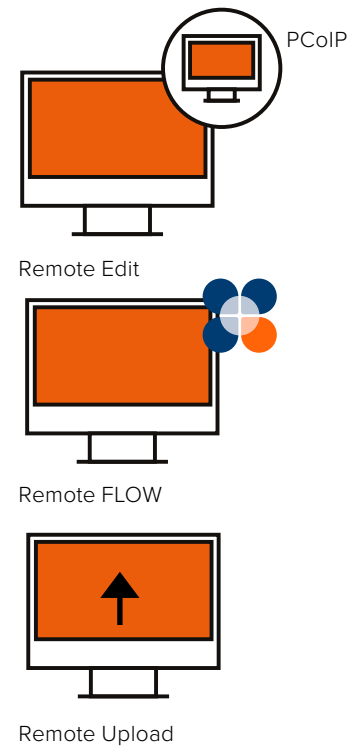

FLEX Cloud Edit - Scale Out

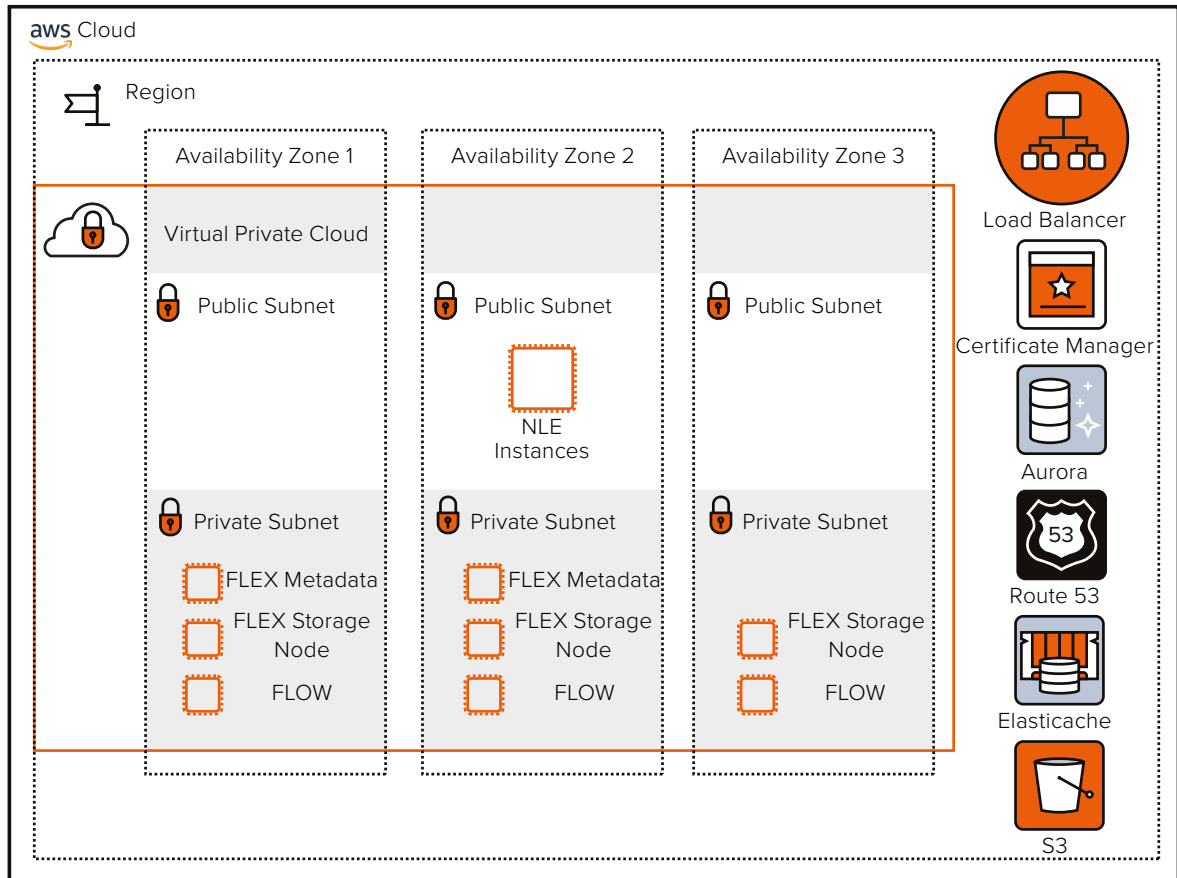

Remote client options

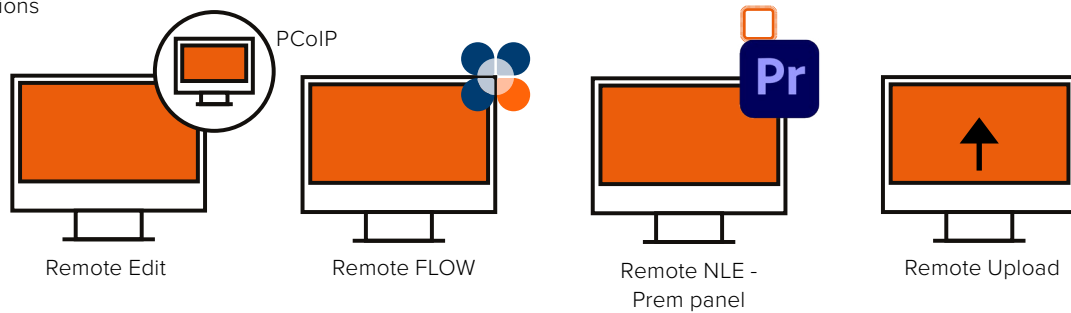

To discuss your options, including more complex deployments of the solution, please get in touch with the team on **03332 409 210** or at **media@Jigsaw24.com**.

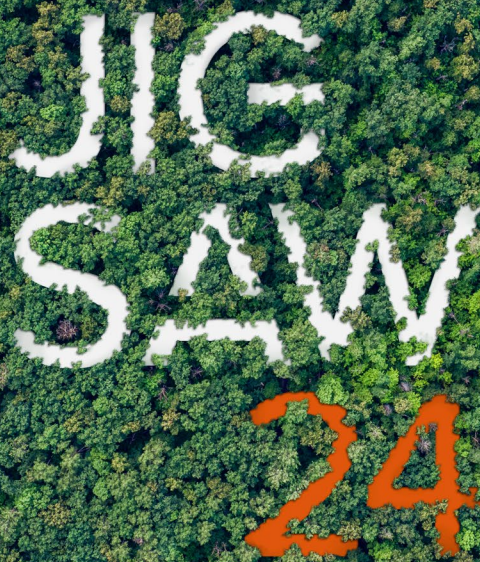

The bigger picture

Enabling remote working helps you to cut overheads and work with a wider pool of talent. But it can also have a huge impact on your facility's green footprint.

More and more, clients want to know they're investing in companies that take their environmental responsibilities seriously, with many firms vetting potential collaborators based on their green credentials.

Moving from ageing on-premise hardware to a more efficient cloud workflow is a fantastic first step in your business's journey to more sustainable working. It also means that you can spin up and down workstations based on need, rather than increasing your energy consumption by maintaining hardware and rooms you only need during peak times. And if your clients, talent and management are all based in different locations, enabling remote working allows you to cut down on travel emissions and congestion (as well as saving everyone time).

Want to know more about our environmental policies and how we're helping make the media industry greener? Visit [Jigsaw24.com/environment](https://jigsaw24.com/environment).

How are we helping?

We're keenly aware that the industry needs to act fast to reduce its impact on the environment and keep our planet safe. That's why, alongside working with our supply chain partners to reach carbon net zero, we're alert to every opportunity to take action and make an impact on our environmental footprint, and we put pressure on our partners to do the same. We know the media industry has a lot to answer for, and we want to be leaders when it comes to helping the sector find a new way forward.

We've switched our Nottingham premises over to 100% UK-generated renewable energy. We're working on electric vehicle schemes, improving the energy efficiency of our old mill HQ, and have offset 800 tonnes of carbon with the help of The Woodland Trust, with whom we've planted over 3000 native trees.

We are aligning ourselves with The Greenhouse Gas Protocol (GHG) - the international standard for greenhouse gas reporting. We tackled Scope 1 (our direct emissions) and Scope 2 (indirect emissions) over the course of this year, and achieved an EcoVadis Silver Award, putting us in the top 10% of companies signed up to the programme.

We've long worked to the WEEE hardware recycling standard, meaning we dispose of electronic waste cleanly on behalf of all our customers. As of this year, approximately 82% of our waste is recycled with Veolia, and the remaining 18% is incinerated to produce electricity. We also adhere to REACH, ESOS, MEES and SECR standards, and are working to eliminate printing and plastic waste from our organisation.

In addition to improving our own waste production, we've been working with local firms to reduce our delivery footprint, hire electric vehicles, and foster responsible partnerships with vendors such as Apple, which has its own high-level sustainability policies, as well as Avid, HP, Dell, Quantum, Microsoft and Adobe.



Contact us

At our Nottingham HQ, for sales queries and consultancy:

Call: 03332 409 210

Email: media@Jigsaw24.com

Visit: media.Jigsaw24.com

In our Soho Experience Centre, for demos and meetings:

Call: 03332 409 285

Email: soho@Jigsaw24.com

Visit: Jigsaw24.com/soho

For support:

Call: 03332 409 373

Email: mediasupport@Jigsaw24.com

On social media:

 [@Jigsaw24Media](https://twitter.com/Jigsaw24Media)

 [Jigsaw24Media](https://www.linkedin.com/company/Jigsaw24Media)